

DIGGER / AG

SUBMERSIBLE PUMP FOR HEAVY DUTY - SUSPENSION AND SAND MIXTURE

POWER: 1.5 ~ 3.7 kW

MAX. HEAD: 25 m

MAX. CAPACITY: 75 m³/h (1,25 m³/min)



PRODUCT NOMENCLATURE

Example 1: Digger 3 / AG - 3 3

FEATURES

- Design for civil engineering, light weight for easy portability and double outer casing water cooling motor make it possible to run the pump to low water level.
- Best waterproof structure, automatic rest motor protector and double mechanical seal made of silicon carbide. Durable and leakproof.
- Compact, strong design and easy operation in any place.
- Equipped with a cast iron agitator to create powerful stirring and pumping action for slurry.
- Impeller made of high chrome alloy (HCR) steel with a hardness of 55 ~ 60 HRC.



APPLICATIONS

- Dewatering of building pits
- Drainage Systems
- Drain cavities, shafts and containers
- Well development

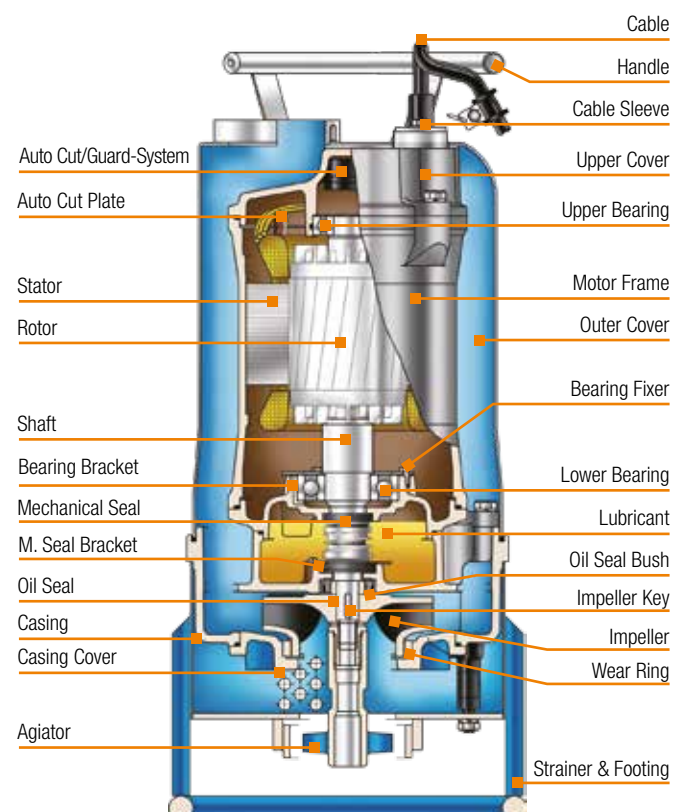

DIGGER / AG

DIGGER 2/AG32 • DIGGER 3/AG33 • DIGGER 5/AG35



DIGGER2/AG32
DIGGER3/AG33
DIGGER5/AG35

MATERIAL OVERVIEW

| TECHNICAL DESCRIPTION | | |
|-----------------------|------------------|--|
| LIMITS OF USE | Liquid Temp. | 0 ~ 40 °C |
| | Applications | Sand mixture and suspension up to 10.5 mm solids passing |
| | Submersion Depth | 30 m |
| TYPE | Frequency | 50 Hz |
| | Motor | 2P • Dry Motor |
| | Insulation | Class B (3,7 kW: Class F) |
| | Protection | IP68 |
| | Protector | Auto Cut / Guard System |
| | Bearing | Ball Type |
| | M.Seal | Double M. Seal |
| | Impeller | Vortex Impeller |
| MATERIAL | Outer Cover | Stainless Steel (1.4301) |
| | Upper Cover | Cast Iron (GGL 200) |
| | Motor Frame | Stainless Steel (1.4301) |
| | Main shaft | Stainless Steel (1.4301) |
| | M.Seal | Upper: Carbon/Ceramic Lower: Silicon/Silicon |
| | Casing | Cast Iron (GGL 200) |
| | Impeller | HCR |
| | Wear Ring | Ductile graphite iron (GGG-40) |
| | Agiator | Modular graphite casting (GGG-70) |
| | Cable | H07RN-F |



Vortex Impeller

DIMENSIONS

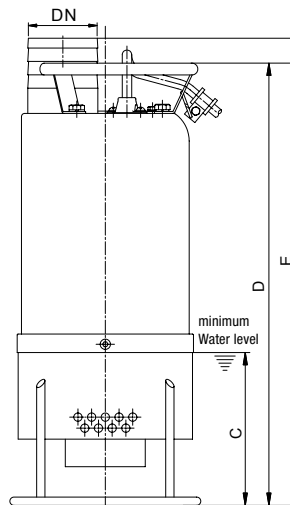
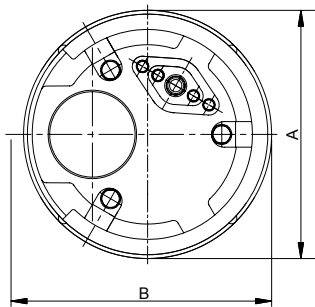

DIGGER2/AG32 • DIGGER3/AG33 • DIGGER5/AG35

| MODEL | DIMENSIONS - MM | | | | | |
|--------------|-----------------|-----|-----|-----|-----|-----|
| | DN | A | B | C | D | E |
| DIGGER2/AG32 | 80 | 243 | 256 | 194 | 562 | 593 |
| DIGGER3/AG33 | 80 | 243 | 256 | 194 | 562 | 593 |
| DIGGER5/AG35 | 80 | 238 | 252 | 194 | 587 | 618 |



PERFORMANCE CURVES

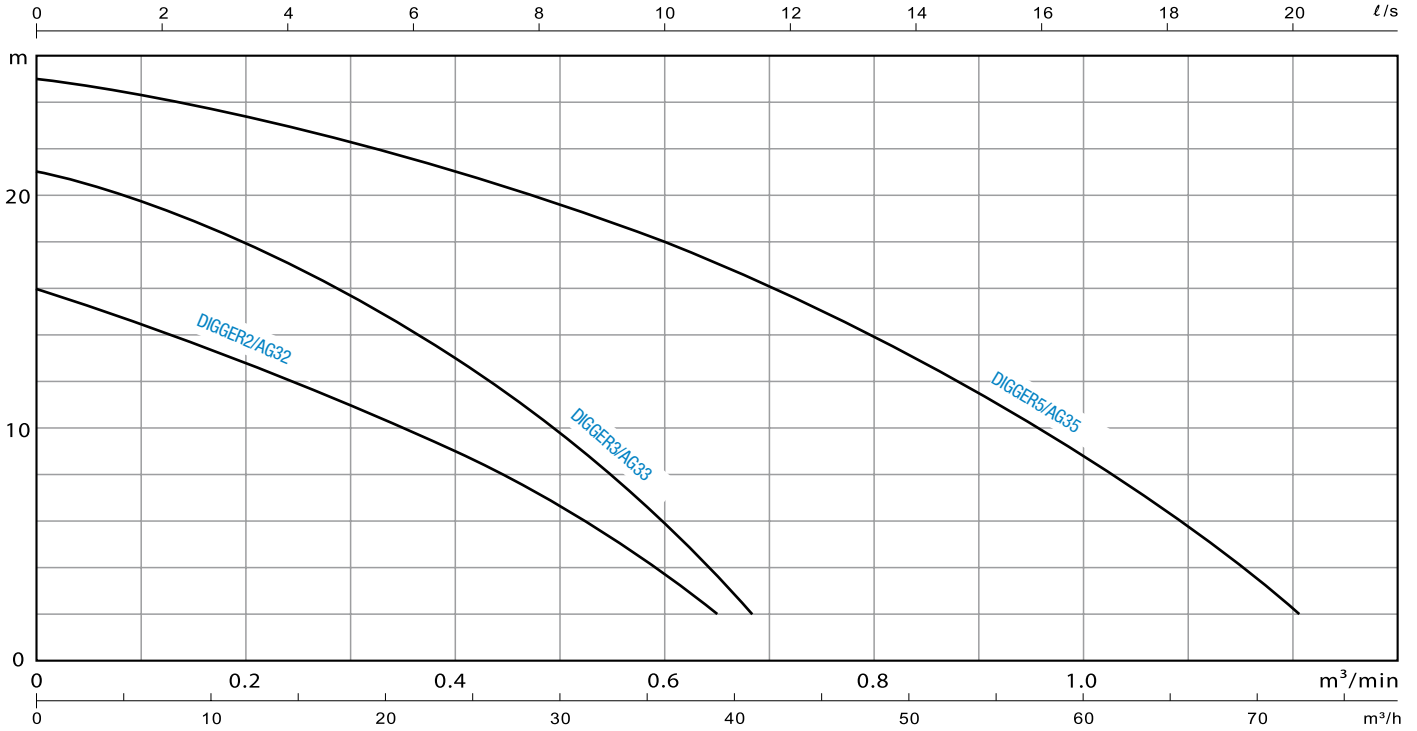

| MODEL | POWER kW | DISCHARGE mm (Inch) | Q:m³/min Q:m³/h | 0.1 | 0.2 | 0.3 | 0.4 | 0.5 | 0.6 | 0.8 | 1,2 |
|--------------|-------------|------------------------|--------------------|------|------|------|------|------|------|------|-----|
| | | | | 6 | 12 | 18 | 24 | 30 | 36 | 48 | 72 |
| DIGGER2/AG32 | 1.5 | 80 (3") | H:m | 15.0 | 13.2 | 11.3 | 9.1 | 6.5 | 3.5 | / | / |
| DIGGER3/AG33 | 2.2 | 80 (3") | | 19.7 | 18.0 | 15.7 | 13.0 | 9.8 | 5.9 | / | / |
| DIGGER5/AG35 | 3.7 | 80 (3") | | 24.3 | 23.4 | 22.3 | 21.0 | 19.5 | 18.0 | 14.0 | 2.3 |



SPECIFICATIONS

| MODEL | POWER kW | DISCHARGE mm (Inch) | STANDARD | | MAX | | SOLID PASSAGE mm | WEIGHT (without Cable) 400 V - kg | CABLE LENGTH | SPEED RPM |
|--------------|-------------|------------------------|----------|---------|-------------|-----------|------------------------|---|-----------------|--------------|
| | | | m-m³/min | m-m³/h | m-m³/min | m-m³/h | | | | |
| DIGGER2/AG32 | 1.5 | 80 (3") | 9 - 0.4 | 9 - 24 | 16 - 0.7 | 16 - 42 | 10.5 | 38 | 20 m | 2900 |
| DIGGER3/AG33 | 2.2 | 80 (3") | 13 - 0.4 | 13 - 24 | 21 - 0.72 | 21 - 43.2 | 10.5 | 40 | 20 m | 2900 |
| DIGGER5/AG35 | 3.7 | 80 (3") | 18 - 0.5 | 18 - 30 | 25.5 - 1.25 | 25.5 - 75 | 10.5 | 46 | 20 m | 2900 |

ALL PUMPS AVAILABLE IN RENTAL FLEET

Subject to technical modifications without giving prior notice.
Our general terms and conditions (AGB) apply

DIGGER / AG

SUBMERSIBLE PUMP FOR HEAVY DUTY - SUSPENSION AND SAND MIXTURE

CONSTRUCTION FEATURES:

- HCR Radial Impeller
- Double Mechanical Seal in Silicon Carbide
- Equipped with a modular graphite casting agitator to create powerfull stirring and pumping action for slurry
- Double outer casing water cooled motor design suitable for low water level dewatering
- The integrated HEIDE-Guard-System prevents motor from burn out, detects voltage drop and over-current.

Before operation please connect with a protection plug or insert to a switchboard, which is prepared for motor-current.

CONTENTS OF DELIVERY

- 3-phase pumps with 20 m cable (H07RN-F), bare cable end

ACCESSORIES AND OPTIONS

- Control systems
- Protection plug
- Automatic control panel
- Ropes
- pipes, fittings and hoses

ALL PUMPS AVAILABLE IN RENTAL FLEET

Subject to technical modifications without giving prior notice.
Our general terms and conditions (AGB) apply



HEIDE-PUMPEN GmbH

Am Maibusch 102 – 106
45883 Gelsenkirchen

phone +49 (0) 209 941 39-0
fax +49 (0) 209 941 39-99

info@heide-pumpen.de
www.heide-pumpen.de

NOTES

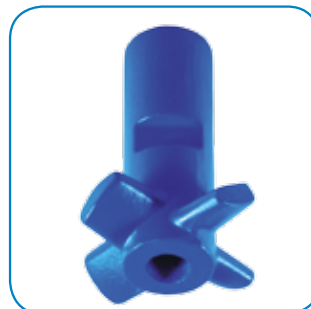
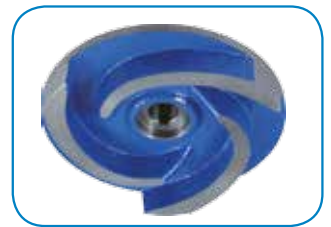

External Hand-O-Automatic control with 2 electrodes



Protection Plug with phase inverter and rotational direction control

